

vertical section

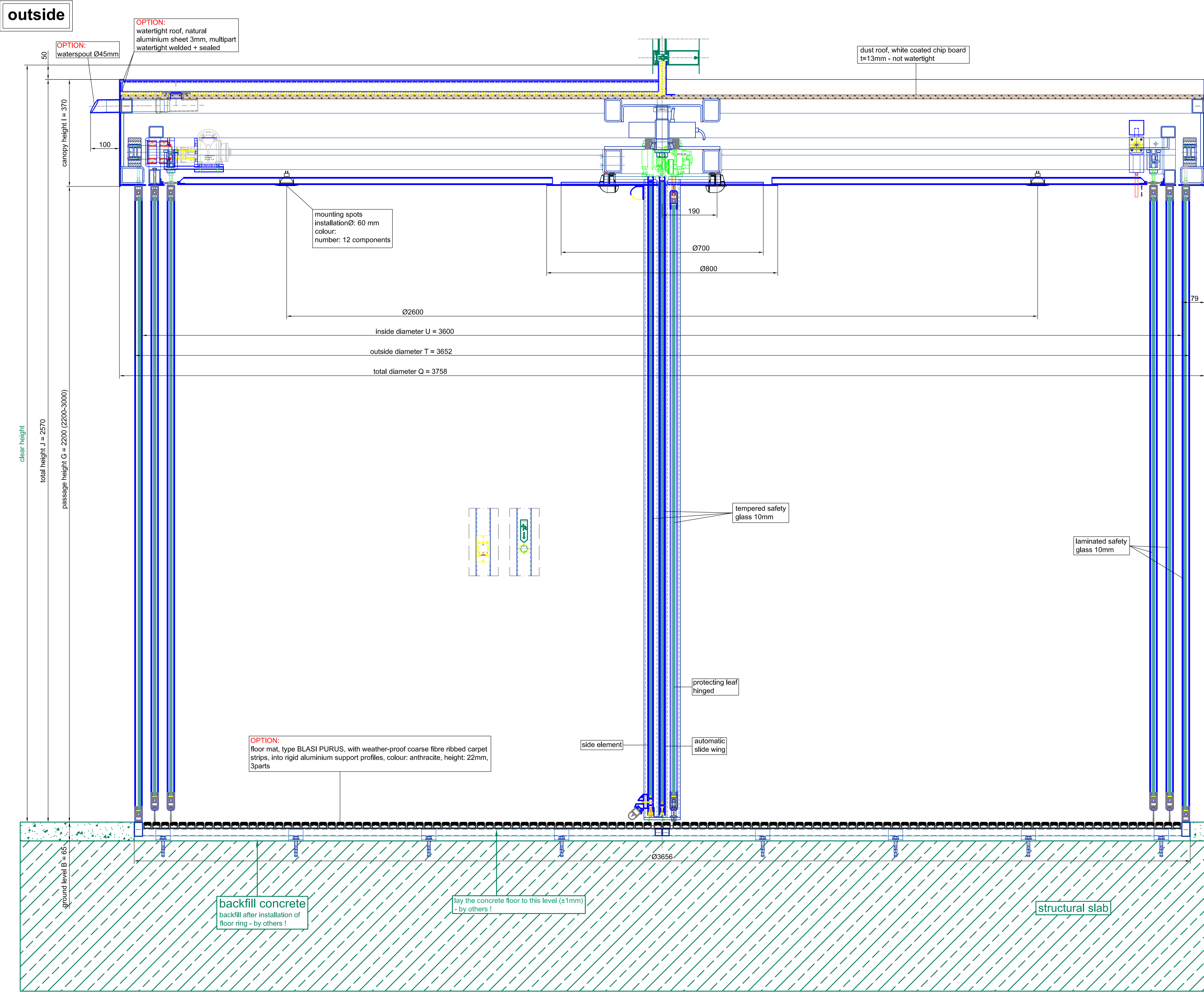

vertical section - dust roof / outside

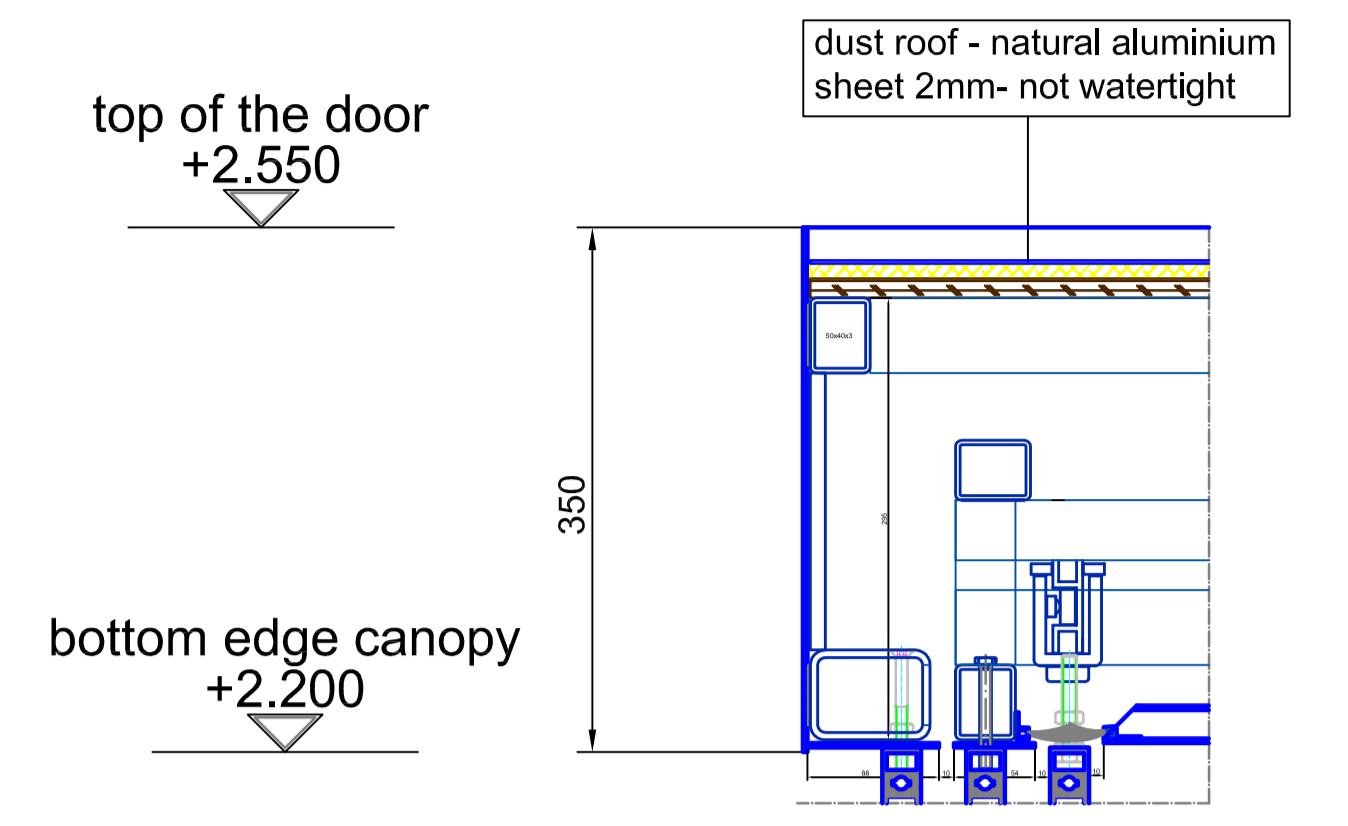

vertical section - watertight roof - multipart

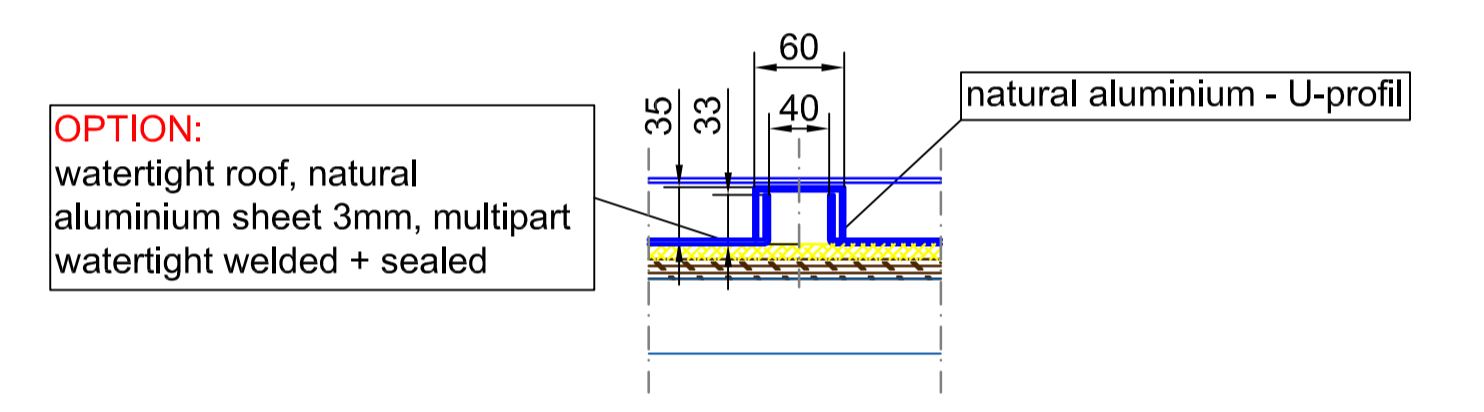

vertical section - passage area / inside

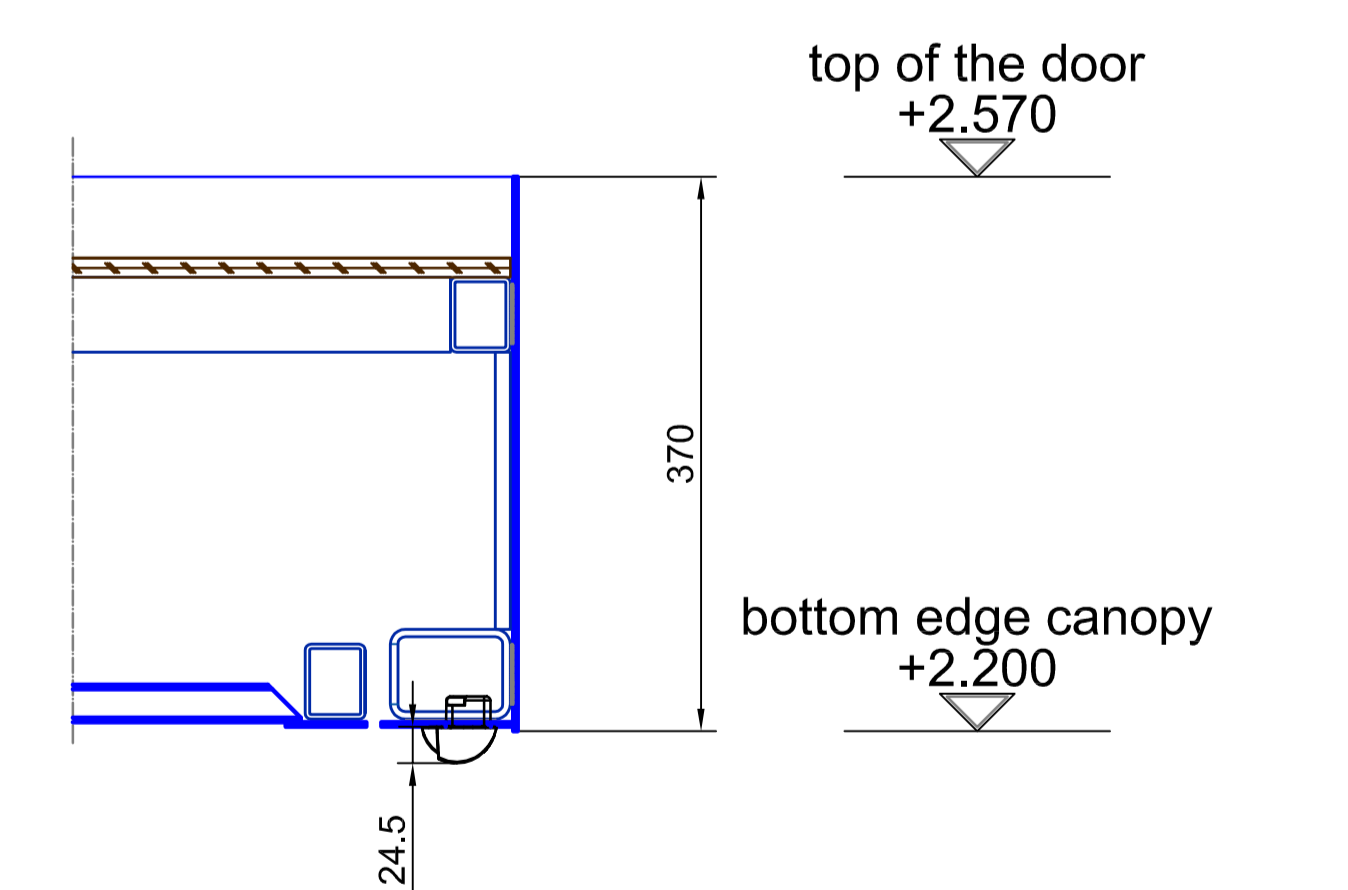

Surface:	All visible screws 304 s/s (DIN 7991)	All green marked components must be executed by others!
Single glasses:	tempered safety glass 10 mm	laminated safety glass 10 mm
Curve glasses:		
Scale:	A0 = M 1:5	Confirmation No.:
Type:	K21-S/SF-36	Date:
Project:	SAMPLE DRAWING ONLY	Name:
Contractor:		
Checked:		Page 01
Arranged:		From 04

BLASI
B L A S I G m b H
Tel: +497822 / 893 - 291
Fax: +497822 / 893 - 299
E-mail: info@blasi.info
www.blasi.info

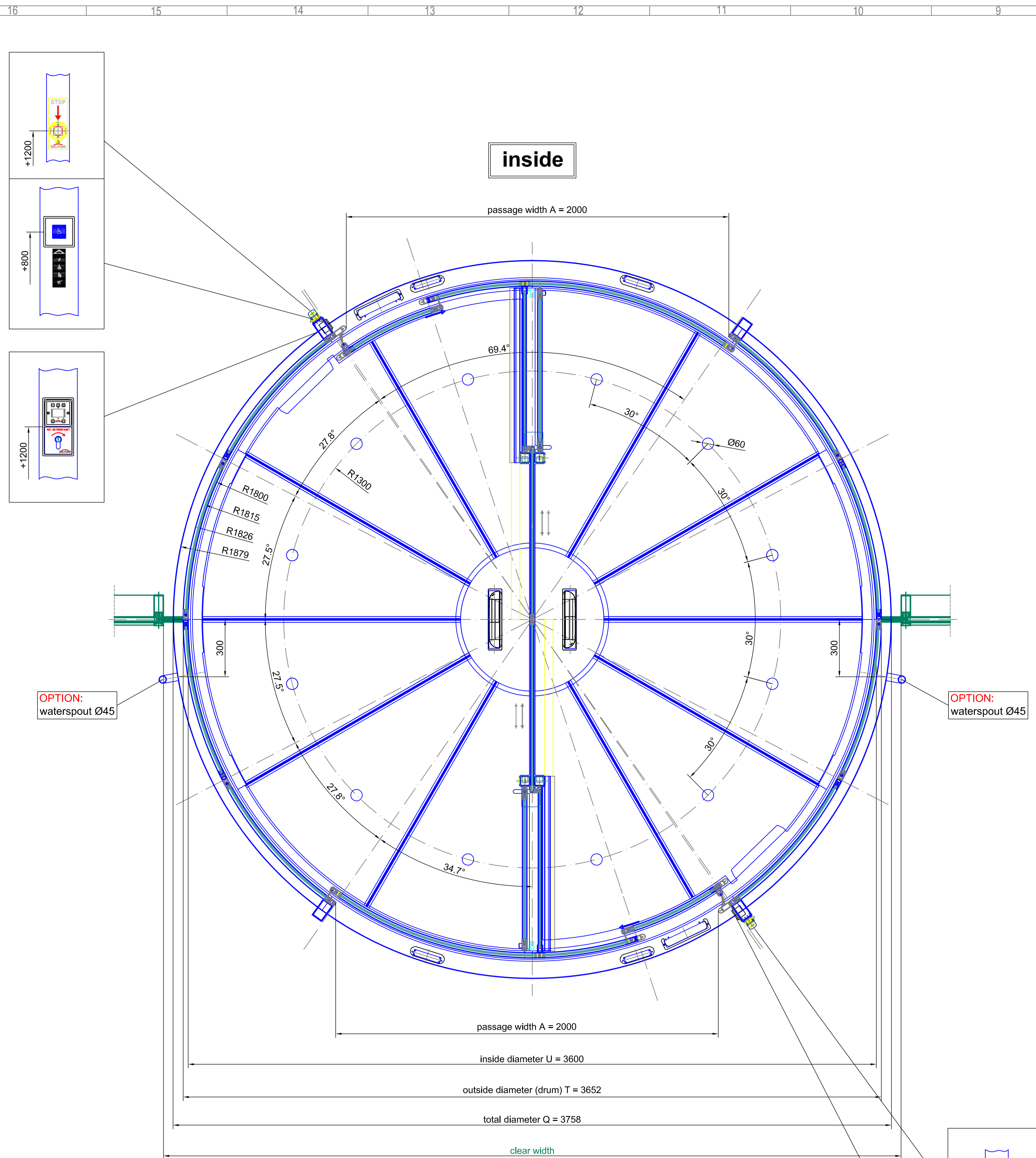

horizontal section - door in standard position

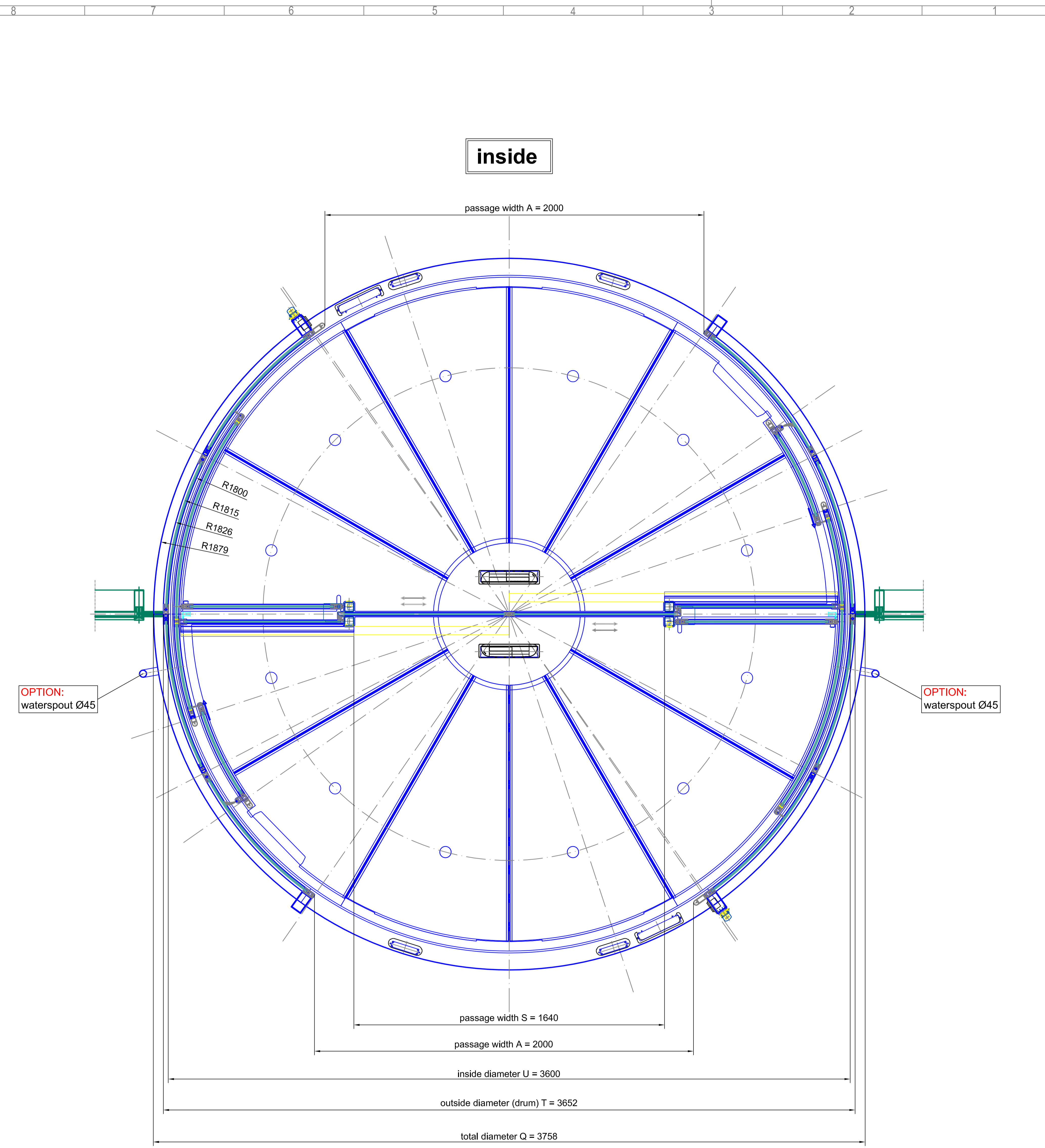

horizontal section - door in open door position

Surfaces:	All visible surfaces 304 s/s (DIN 7991)	All green marked components must be executed by others!!!	
Straight glasses:	tempered safety glass 10 mm	Curved glasses:	laminated safety glass 10 mm
Notes:	Modifications	Scale:	A0 = M 1:10
		Confirmation No.:	
		Date:	
		Name:	
		Project: K21-S/SF-36 Type: SAMPLE DRAWING ONLY	
B L A S I G m b H Automatic Doors Carl-Benz-Street 5-15 D - 77972 Mannheim		Tel: +497822 / 893 - 291 Fax: +497822 / 893 - 299 E-mail: info@blasi.info www.blasi.info	
Checked:	Arranged:	Drawing No.:	Page: 02
			From: 04

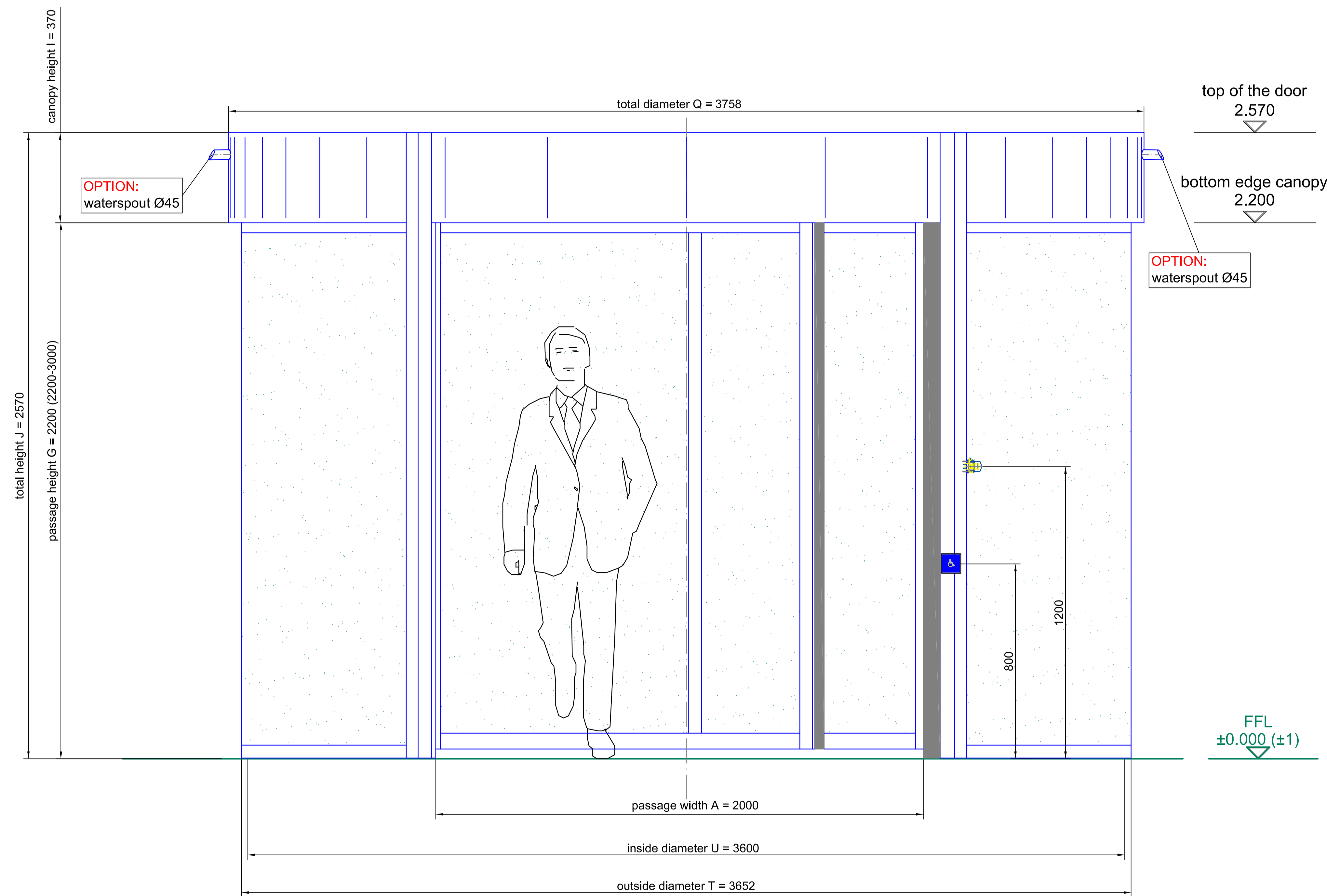

front elevation - outside

Surface:	All visible surfaces 304 s/s (DIN 7991)	All green marked components must be executed by others!!!
Straight glasses:	tempered safety glass 10 mm	Curved glasses: laminated safety glass 10 mm
Notes:	Modifications:	Scale: A0 = M 1:10 Confirmation No.: Date: Name:
		Project: K21-S/SF-36
B L A S I G m b H Automatic Doors Carl-Benz-Street 5-15 D - 77972 Mannheim		Tel: +497822 / 893 - 291 Fax: +497822 / 893 - 299 E-mail: info@blasi.info www.blasi.info
Checked:	Arranged:	Page: 03 From: 04
<small>This drawing is the property of the company Blasi. It is not allowed to be duplicated or to be resold to a third party. Technical modifications are under reserve.</small>		

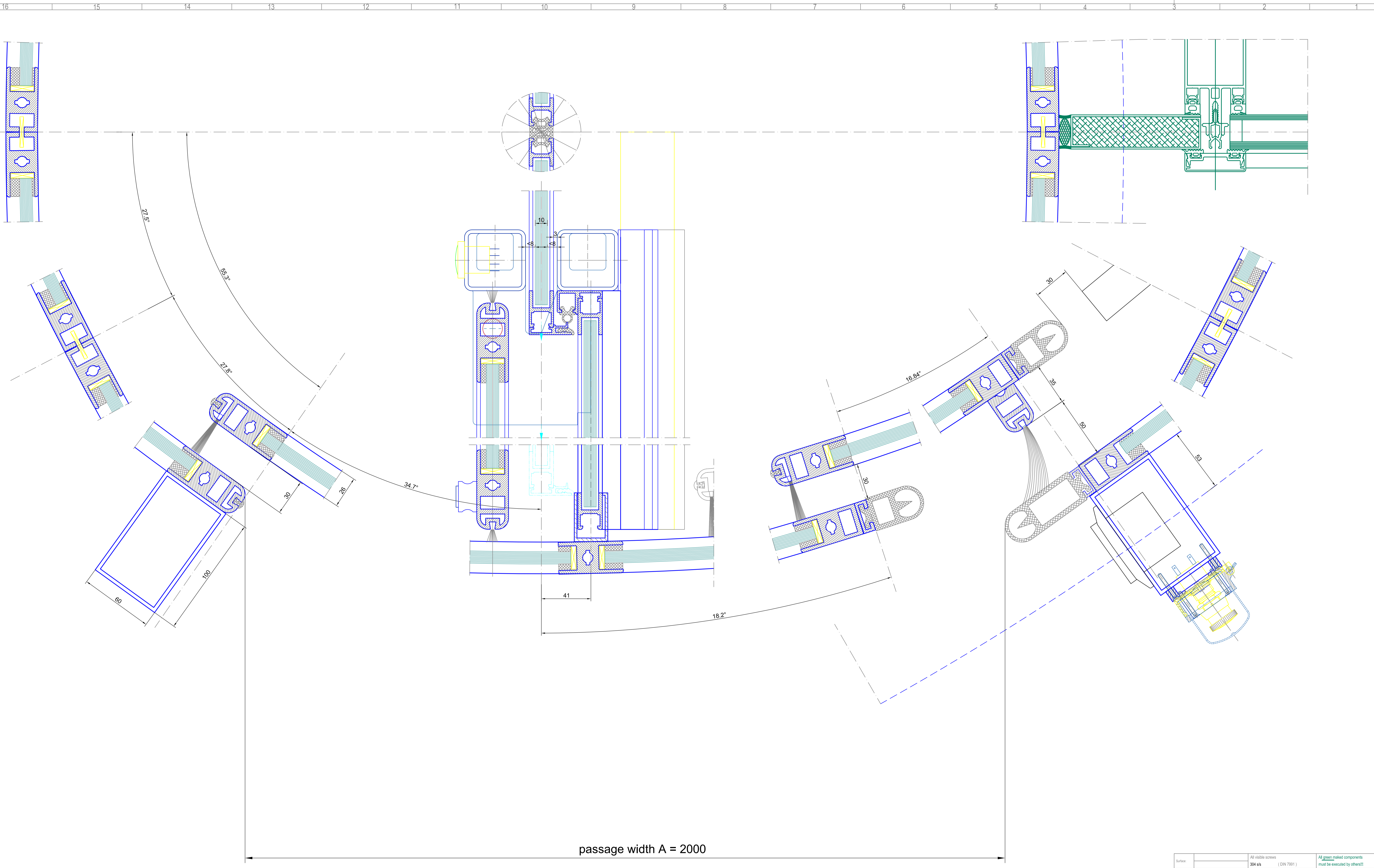

horizontal section - details

passage width A = 2000

Surface:	All visible surfaces 304 s/s (DIN 7981)	All green marked components must be executed by others!!!
Single glasses:	tempered safety glass 10 mm	laminated safety glass 10 mm
Corner glasses:		
Notes:	Modifications:	
Scale:	A0 = M 1:1	Confirmation No.:
Type:	K21-S/SF-36	Date:
Project:	SAMPLE DRAWING ONLY	Name:
Contractor:		
Checked:	Arranged:	Page: 04
		From: 04

BLASI
 B L A S I G m b H
 Carl-Benz-Street 5-15
 D - 77972 Mannheim
 Tel. +497822 / 893 - 291
 Fax. +497822 / 893 - 299
 E-mail: info@blasi.info
 www. Blasi . info

This drawing is the property of the company Blasi. It is not allowed to be duplicated or to be resold to a third party. Technical modifications are under reserve.